



Art.-Nr: FLU50ML
Emergency light, General light Centralised power supply systems
Universal, CPS, IP66, Zinc die-cast, Anthracite

Robust ceiling-mounted Aluminium die-cast luminaire for the lighting of escape and rescue routes according to DIN EN 60598-1, DIN EN 605982-22 and EN 1838.

The IP66 flood light is suitable for indoor and outdoor use. Due to the wide beam angle, large areas can be easily illuminated. The MU05 monitoring module is installed in the supplied separate housing.

Control and monitoring via central power supply system.



More information
www.rp-group.com/en/item/FLU50ML



TECHNICAL DATA

Luminaire type	Emergency light, General light
Mounting	Universal
Pictograph	No
Illuminant	LED
Housing material	Zinc die-cast
Housing color	Anthracite
Protection type (IP)	IP66
Impact resistance (IK)	8
Certification	CE, WEEE, RoHS, ENEC, TÜV Rheinland Type approved
Insulation class	1
Supply	Centralised power supply systems
Monitoring	Central power supply (ML)
Bridging time	CPS
Battery	/
Operating mode	Non-maintained
Input voltage AC	230 V
Input frequency	50 / 60 Hz
Input voltage DC	216 V
Power max.	51,5 W



Power maintained	51,5 W
Power non-maintained	1,5 W
Ambient temperature maintained mode	-25 °C to 40 °C
Ambient temperature non-maintained mode	-25 °C to 40 °C
Depth	247 mm
Width	187 mm
Height	37 mm
Weight	6.5
Weight incl. packaging	6.75
Switching input	No
Emergency light blocking	No
Battery connection	No
Dimming function	No
Luminous flux mains	8163 lm
Luminous flux emergency	8163 lm
EOF	1
Customs tariff number	94054239
GTIN	4260682159793



TECHNICAL DRAWING

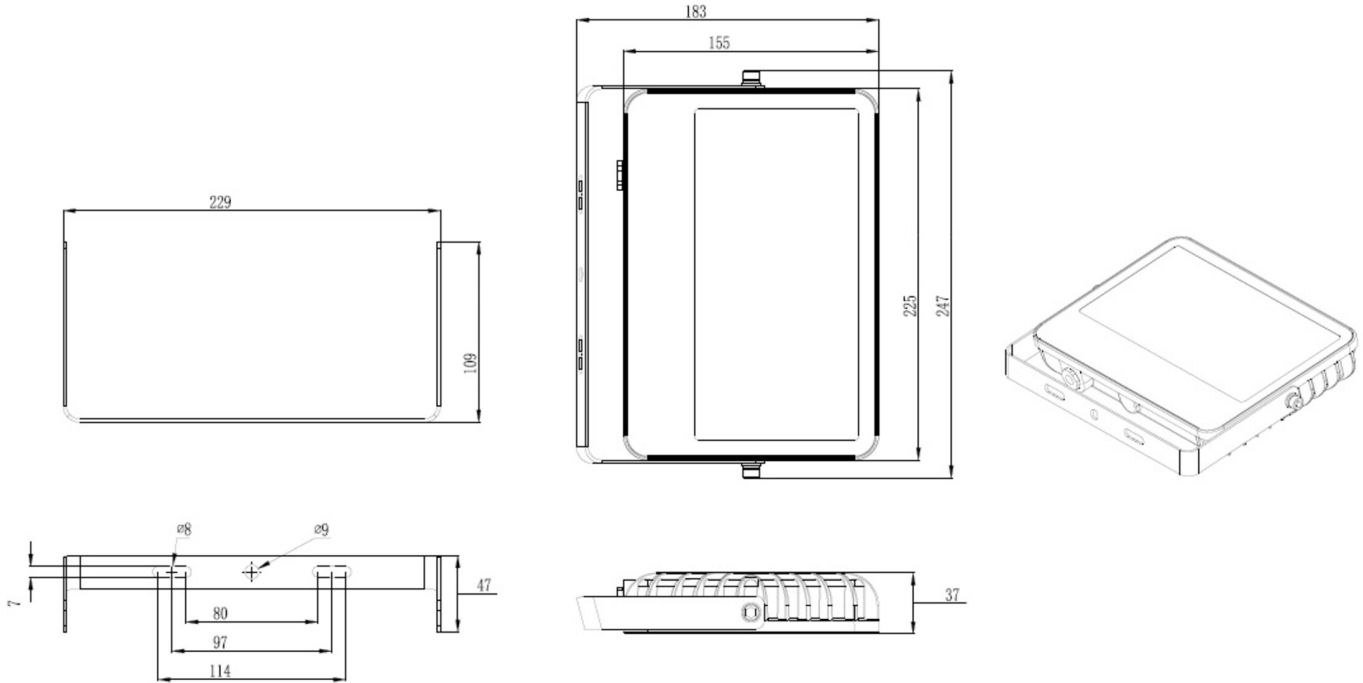

Maße MU05-BOX

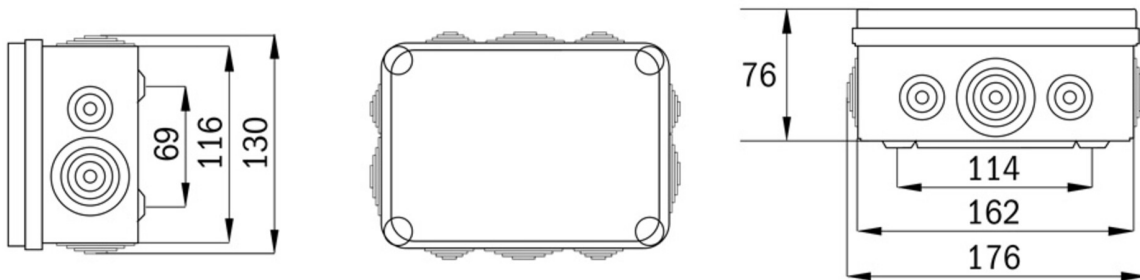

ACCESSORY LIST

MU05-BOX - MU05 Single luminaire monitoring module | IP65/IK07



RELATED PRODUCTS

Art.-No.	Image	Monitoring	Supply	Color	Investment	Automatic log	Maintenance level	Remote maintenance	max. luminaires	Single luminaire monitoring
FLU10ML		Central power supply (ML)	Central power supply	RAL 7016	€€€	Yes	low	Yes	1,920 per system	central
FLU30ML		Central power supply (ML)	Central power supply	RAL 7016	€€€	Yes	low	Yes	1,920 per system	central

As of: 07.07.2026 - Subject to technical changes and errors.