



Art.-Nr: KMUK403SC-SW
Exit sign Self-contained
Universal, 3 h, 24 m, IP43, Polycarbonate, Black, Set of
pictograms, Universal mounting

Slim convex escape sign light with clear closed hood. The universal mounting includes wall and ceiling surface mounting, as well as the possibility of recessed ceiling installation in conjunction with the mounting frame. Planning safety for marking the escape and rescue routes for one- or two-sided lettering is ensured by the tool-free, variable use of the pictograms on site. The pictograms are internal and are inserted solvent-free. The pictogram set (right, left, top and bottom arrow) is included as standard.

Exit sign according to EN 60598-1, EN 605982-22 and EN 1838.

Automatic monitoring of safety luminaire with SelfControl. Planning certainty is provided by tool-free, variable use of the pictograms on site. A set of pictograms corresponding to DIN ISO 7010 (arrow to the right, left, up and down) is supplied as standard. Universal mounting includes fitting on the wall and ceiling as well as the option of fitting in the ceiling in conjunction with the mounting frame available.



More information

www.rp-group.com/en/item/KMUK403SC-SW



TECHNICAL DATA

Luminaire type	Exit sign
Mounting	Universal
Recognition distance	24 m
Pictograph	Set
Illuminant	LED
Housing material	Polycarbonate
Housing color	Black
Protection type (IP)	IP43
Impact resistance (IK)	3
Certification	WEEE, CE
Insulation class	2
Supply	Self-contained
Monitoring	SelfControl (SC)
Bridging time	3 h



Battery	LiFePO4 3,2 V/1,5 Ah
Operating mode	Non-maintained / maintained
Input voltage AC	230 V
Input frequency	50 / 60 Hz
Power max.	3,7 W
Power maintained	3,2 W
Power non-maintained	0,3 W
Ambient temperature maintained mode	0 °C to 40 °C
Ambient temperature non-maintained mode	0 °C to 40 °C
Depth	35 mm
Width	251 mm
Height	177 mm
Weight	0.55
Weight incl. packaging	0.65
Connection cross-section	1.5 mm ²
Switching input	Yes
Emergency light blocking	No
Battery connection	Connector
Dimming function	No
Customs tariff number	94056120
GTIN	4260766553837



TECHNICAL DRAWING

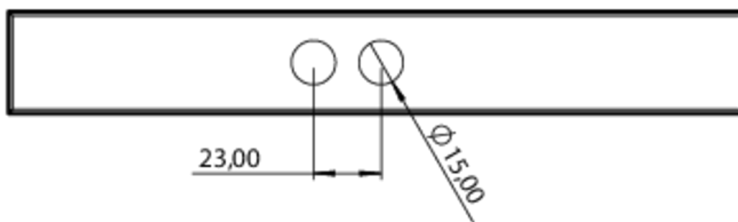
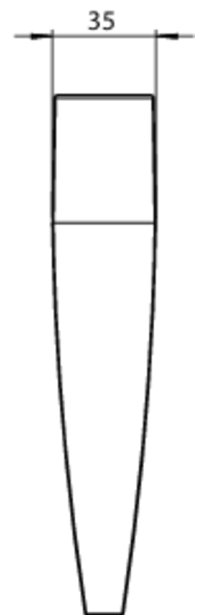
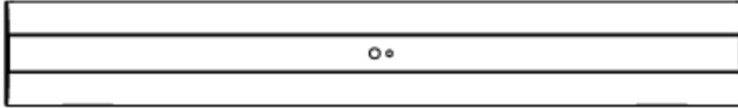



ACCESSORY LIST

DSA - Wire suspension
AWKSU - Wall bracket
2PW-EB - Pendant
KMBE - Concrete-mounted box
BALLPLX-KMU.01 -
KME-SW - Mounting frame

RELATED PRODUCTS

Art.-No.	Image	Monitoring	Supply	Color	Investment	Automatic log	Maintenance level	Remote maintenance	max. luminaires	Single luminaire monitoring
KMUK403SC		SelfControl (SC)	Single battery	RAL 9003	€	no	high	no	unlimited	itself

As of: 04.07.2026 - Subject to technical changes and errors.