

RPower OGiV123400HP (12V 100Ah AGM High-Power-Battery)

with UL94 V-0 Housing

EAN: 4260349823661

Floating Life at 20°C designed for up to 12 years

Dimensions

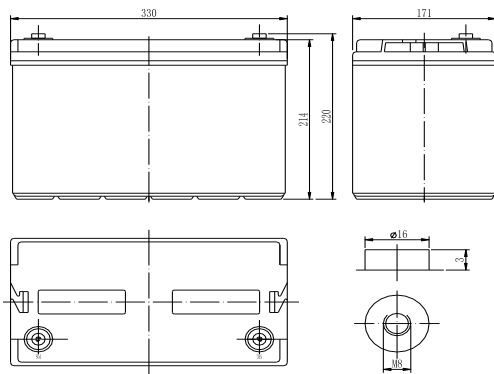

Specifications

Nominal Voltage		12V
Capacity (10hr@25°C@1.80V/C)		100Ah
Dimensions	Length	330mm (13.0inch)
	Width	171mm (6.73inch)
	Height	215mm (8.46inch)
	Total Height	220mm (8.66inch)
Approx. Weight		31.50kg (69.45lbs)
Maximum charging current		30A
Maximum discharge current		900A (5sec.)
Internal resistance		Approx. 4.2mΩ
Capacity affected by temperature (20hr)	40°C	103%
	25°C	100%
	0°C	86%
	-15°C	65%
Self-discharge (25°C)	3 month	Remaining Capacity: 91%
	6 month	Remaining Capacity: 82%
	12 month	Remaining Capacity: 65%
Nominal operating temperature		25°C ±3°C (77°F±5°F)
Operating temperature range		-20°C~55°C (-4°F~131°F)
Float charging voltage (25°C)		13.65 to 13.80V
Cyclic charging voltage (25°C)		14.40 to 15.00V
Terminal material		Copper

The Relationship for Charging Voltage and Temperature

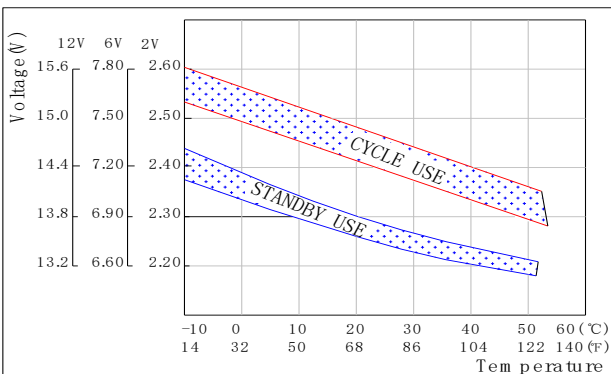

Charging Characteristics (25°C)

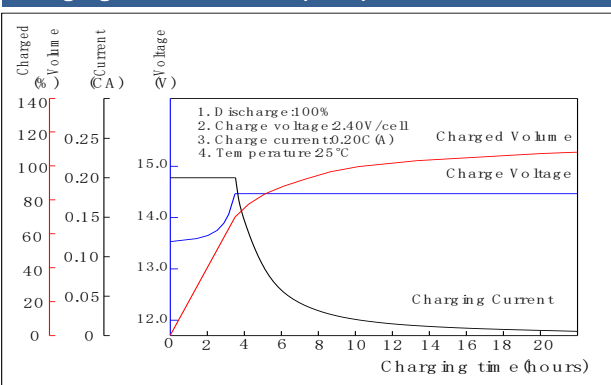

Discharge Characteristics (25°C)

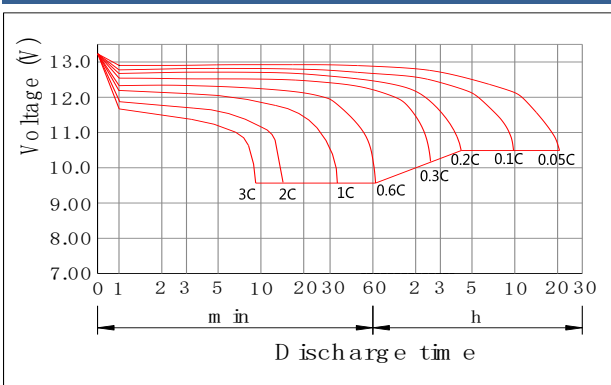

Constant Current Discharge Characteristics (Ampere / Battery, 25°C)

FV / TIME	5min	10min	15min	20min	30min	45min	1h	2h	3h	4h	5h	6h	8h	10h	20h
10.98V	317,50	242,00	184,89	151,01	114,22	79,38	61,95	36,06	27,44	21,68	18,17	15,75	12,63	9,65	5,25
10.80V	328,00	250,00	191,00	156,00	118,00	82,00	64,00	37,31	28,42	22,46	18,82	16,29	13,12	10,02	5,50
10.50V	342,00	267,00	200,00	162,00	120,00	84,00	66,00	38,54	29,37	23,23	19,47	16,90	13,60	10,40	5,73
10.20V	354,00	280,00	210,00	167,00	126,00	89,00	68,00	39,78	30,33	24,00	20,13	17,48	14,08	10,77	5,93
10.02V	368,00	295,00	225,00	178,00	134,00	96,00	70,00	41,02	31,29	24,78	20,79	18,06	14,56	11,15	6,15
9.60V	373,00	317,00	240,00	190,00	146,00	98,00	73,00	42,85	32,70	25,92	21,75	18,91	15,26	11,69	6,48

Constant Power Discharge Characteristics (Watt / Battery, 25°C)

FV / TIME	5min	10min	15min	20min	30min	45min	1h	2h	3h	4h	5h	6h	8h	10h	20h
10.98V	3374,45	2636,83	2026,99	1684,32	1237,10	935,09	691,15	388,43	290,19	234,99	201,13	173,48	136,16	108,23	58,14
10.80V	3486,00	2724,00	2094,00	1740,00	1278,00	966,00	714,00	401,98	300,59	243,47	208,49	179,93	141,24	112,46	60,69
10.50V	3618,00	2862,00	2232,00	1818,00	1344,00	1008,00	756,00	426,38	319,79	258,55	221,51	191,27	150,44	119,46	64,68
10.20V	3726,00	3048,00	2370,00	1938,00	1380,00	1038,00	780,00	440,70	330,72	267,54	229,32	198,05	156,00	125,04	67,73
10.02V	3990,00	3228,00	2520,00	2010,00	1440,00	1068,00	804,00	455,06	341,70	276,58	237,18	205,02	161,60	130,13	70,59
9.60V	4260,00	3408,00	2622,00	2088,00	1524,00	1092,00	822,00	466,07	350,17	283,59	243,31	210,43	166,04	134,64	72,94