



Art.-Nr: AGW009-AZ

Exit sign Centralised power supply systems

Wall mounting, Without monitoring, CPS, 50m, IP40, Zinc die-cast, Anthracite

Modern zinc die-cast emergency exit sign luminaire for surface mounting on the wall and for identifying emergency and escape routes.

It is part of the A series luminaire family, which provides solutions for any mounting and has won the German Design Award for its uniform, straight-line design.

The requested pictogram (arrow to the right, left, up or down) is supplied as standard.



More information
www.rp-group.com/en/item/AGW009-AZ



TECHNICAL DATA

Luminaire type	Exit sign
Mounting	Wall mounting
Recognition distance	50m
Pictograph	acc. to Specification
Illuminant	LED
Housing material	Zinc die-cast
Housing color	Anthracite
Protection type (IP)	IP40
Impact resistance (IK)	≥ 3
Certification	WEEE, CE
Insulation class	2
Supply	Centralised power supply systems
Monitoring	Without monitoring
Bridging time	CPS
Battery	/
Operating mode	Permanent circuit
Input voltage AC	230 V
Input frequency	50 / 60 Hz
Input voltage DC	100-254 V



Power max.	5,2 W
Power maintained	5,2 W
Power non-maintained	0 W
Ambient temperature DS	-5 °C to 40 °C
Ambient temperature BS	-5 °C to 40 °C
Depth	51 mm
Width	517 mm
Height	296 mm
Weight	2.84
Weight incl. packaging	3.49
Connection cross-section	1.5 mm ²
Switching input	No
Emergency light blocking	No
Battery connection	No
Dimming function	No
Customs tariff number	94056180
EAN	4260659565572



TECHNICAL DRAWING

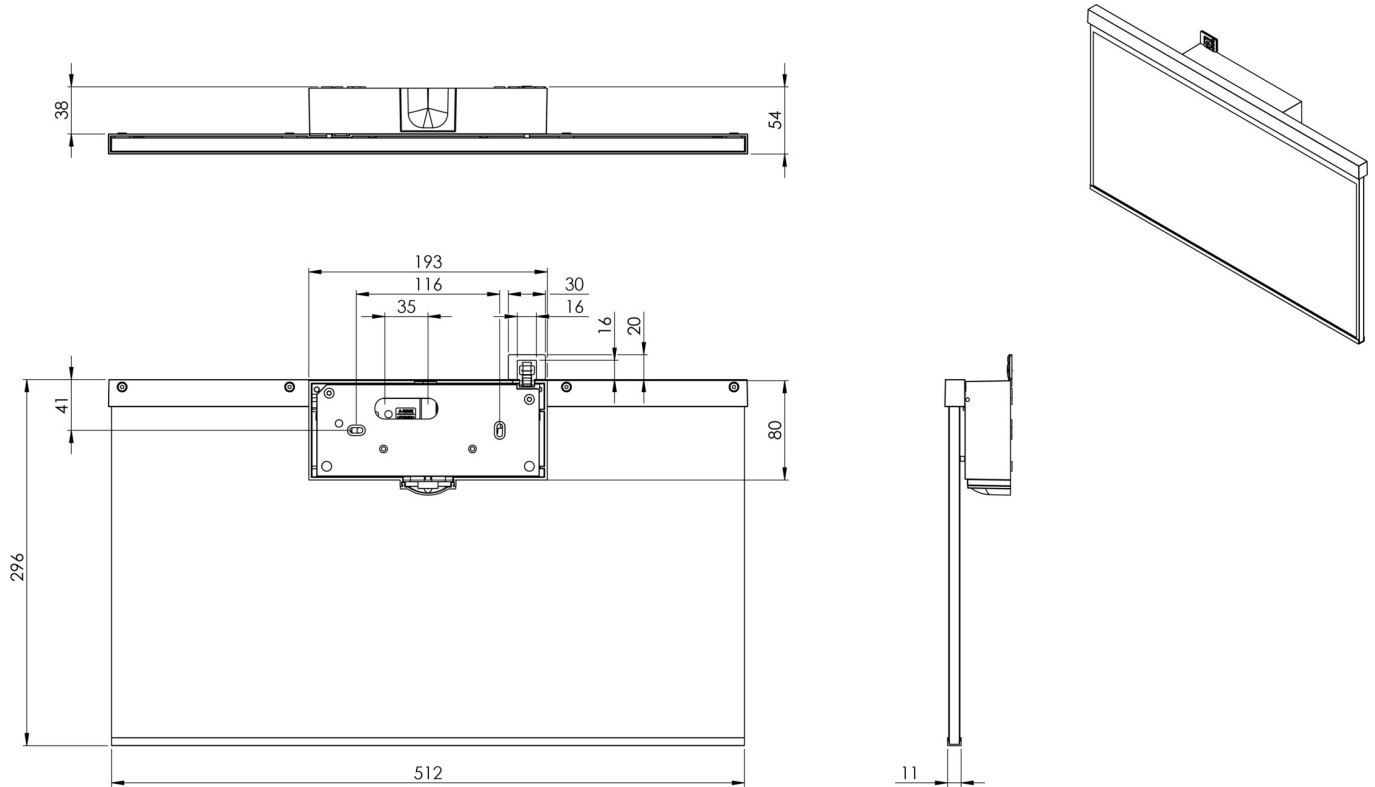

As of: 31.01.2025 - Subject to technical changes and errors.