



Art.-Nr: AGW403WL-E
Exit sign Self-contained
Wall mounting, Wireless Professional (WL), 3 h, 50m, IP40,
Zinc die-cast, Stainless steel

Modern zinc die-cast emergency exit sign luminaire for surface mounting on the wall and for identifying emergency and escape routes.

It is part of the A series luminaire family, which provides solutions for any mounting and has won the German Design Award for its uniform, straight-line design.

Wireless central control and monitoring for large installations of up to 50,000 luminaires with Wireless Professional. The requested pictogram (arrow to the right, left, up or down) is supplied as standard.



More information
www.rp-group.com/en/item/AGW403WL-E



TECHNICAL DATA

| | |
|------------------------|-----------------------------|
| Luminaire type | Exit sign |
| Mounting | Wall mounting |
| Recognition distance | 50m |
| Pictograph | acc. to Specification |
| Illuminant | LED |
| Housing material | Zinc die-cast |
| Housing color | Stainless steel |
| Protection type (IP) | IP40 |
| Impact resistance (IK) | ≥ 3 |
| Certification | WEEE, CE, 5 years warranty |
| Insulation class | 2 |
| Supply | Self-contained |
| Monitoring | Wireless Professional (WL) |
| Bridging time | 3 h |
| Battery | LiFePO4 6,4 V/1,2 Ah |
| Operating mode | Non-maintained / maintained |
| Input voltageAC | 230 V |
| Input frequency | 50 Hz |



| | |
|---|---------------------|
| Power max. | 7 W |
| Power maintained | 5,6 W |
| Power non-maintained | 0,8 W |
| Ambient temperature maintained mode | -5 °C to 40 °C |
| Ambient temperature non-maintained mode | -5 °C to 40 °C |
| Depth | 51 mm |
| Width | 517 mm |
| Height | 296 mm |
| Weight | 3.02 |
| Weight incl. packaging | 3.67 |
| Connection cross-section | 2.5 mm ² |
| Switching input | Yes |
| Emergency light blocking | Yes |
| Battery connection | Connector |
| Dimming function | Yes |
| Customs tariff number | 94056180 |
| EAN | 4260682152701 |



TECHNICAL DRAWING

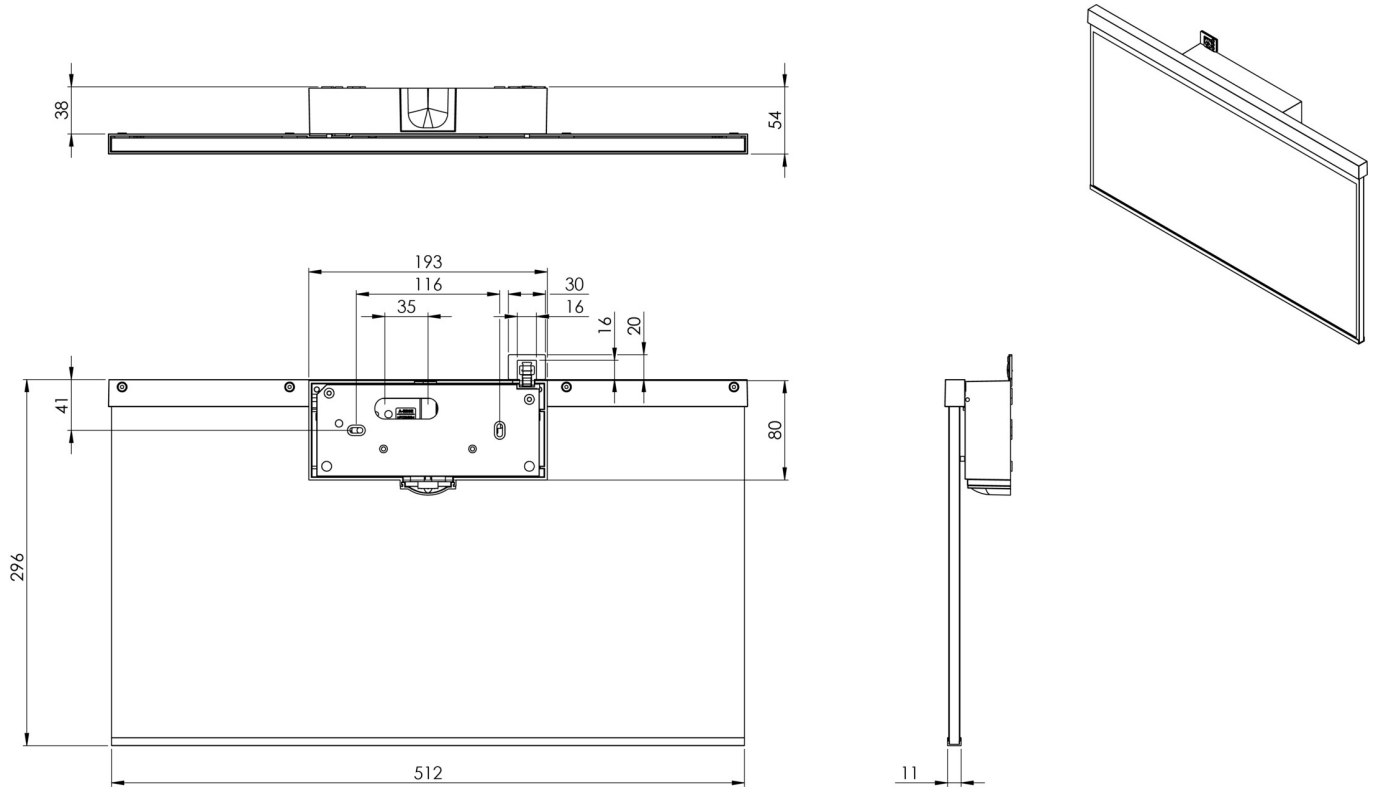

As of: 16.04.2025 - Subject to technical changes and errors.