



Art.-Nr: AGW408SC-AZ
Exit sign Self-contained
Wall mounting, SelfControl (SC), 8 h, 50m, IP40, Zinc die-cast, Anthracite

Modern zinc die-cast emergency exit sign luminaire for surface mounting on the wall and for identifying emergency and escape routes.

It is part of the A series luminaire family, which provides solutions for any mounting and has won the German Design Award for its uniform, straight-line design.

Automatic monitoring of safety luminaire with SelfControl. The requested pictogram (arrow to the right, left, up or down) is supplied as standard.



More information

www.rp-group.com/en/item/AGW408SC-AZ



TECHNICAL DATA

Luminaire type	Exit sign
Mounting	Wall mounting
Recognition distance	50m
Pictograph	acc. to Specification
Illuminant	LED
Housing material	Zinc die-cast
Housing color	Anthracite
Protection type (IP)	IP40
Impact resistance (IK)	≥ 3
Certification	WEEE, CE, 5 years warranty
Insulation class	2
Supply	Self-contained
Monitoring	SelfControl (SC)
Bridging time	8 h
Battery	LiFePO4 6,4 V/1,2 Ah
Operating mode	Non-maintained / maintained
Input voltageAC	180 V - 250 V
Input frequency	50 Hz
Power max.	2,6 W
Power maintained	1,7 W



Power non-maintained	0,9 W
Ambient temperature maintained mode	-5 °C to 40 °C
Ambient temperature non-maintained mode	-5 °C to 40 °C
Depth	51 mm
Width	517 mm
Height	296 mm
Weight	3.02
Weight incl. packaging	3.67
Switching input	Yes
Emergency light blocking	No
Battery connection	Connector
Dimming function	No
Customs tariff number	94056180
EAN	4262483021262

TECHNICAL DRAWING

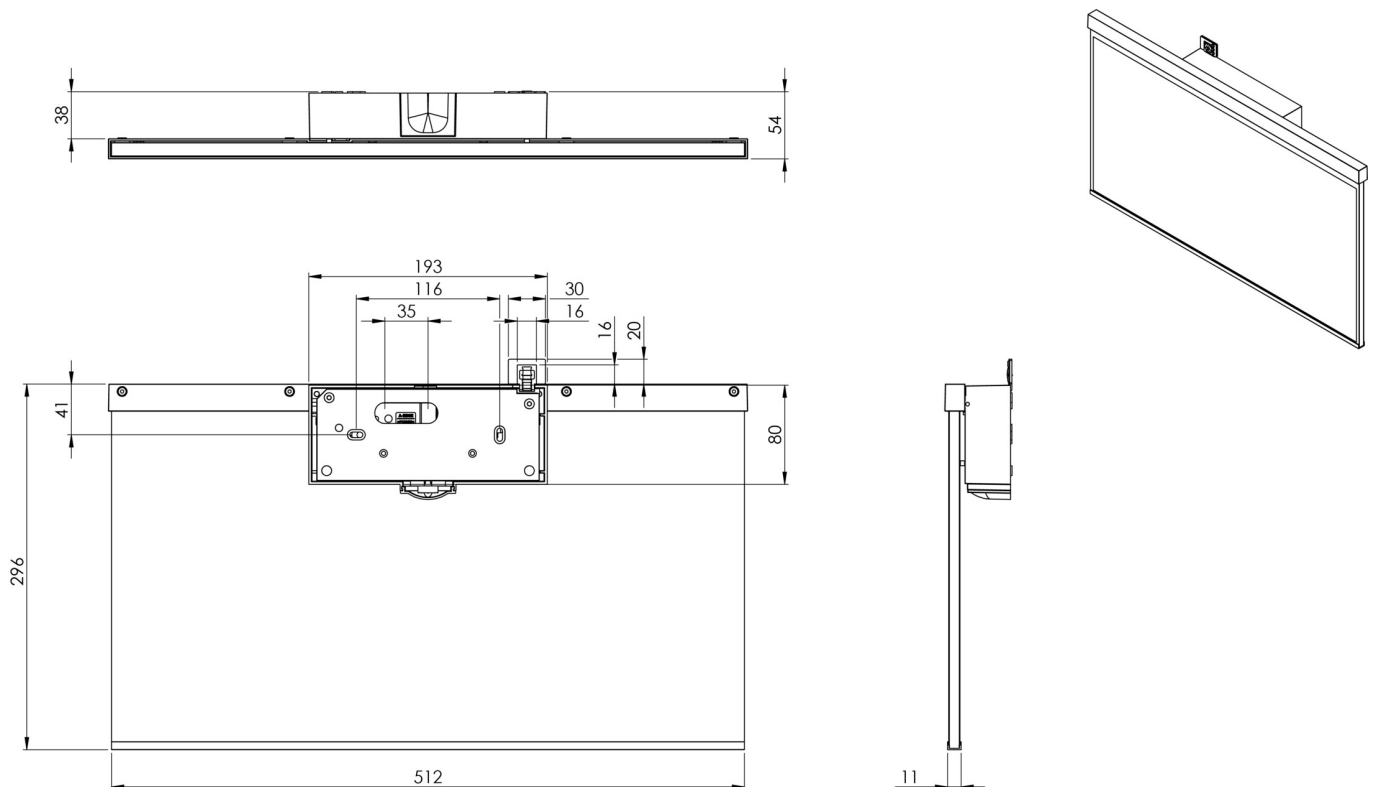

As of: 16.04.2025 - Subject to technical changes and errors.