



**Art.-Nr: DOE023SC-OEM**  
**Emergency light Self-contained**  
**Ceiling mounting, SelfControl (SC), 3 h, , IP20, Polycarbonate,**  
**Transparent**

Small LED safety luminaire, for recessed and surface mounting, with great effect. The small dimensions and transparent housing material make completely unobtrusive mounting possible.

This variant is intended for installation in ceilings. The mounting plate/clips, as well as the emergency light technology in a housing with strain relief, are supplied.

Automatic monitoring of safety luminaire with SelfControl.

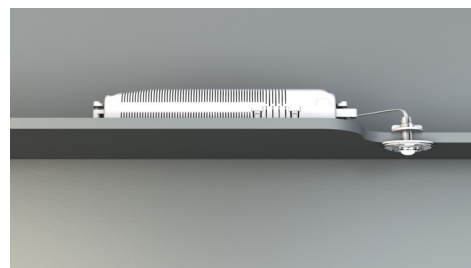

More information  
[www.rp-group.com/en/item/DOE023SC-OEM](http://www.rp-group.com/en/item/DOE023SC-OEM)



## TECHNICAL DATA

Luminaire type	Emergency light
Mounting	Ceiling mounting
Pictograph	No
Illuminant	LED
Housing material	Polycarbonate
Housing color	Transparent
Protection type (IP)	IP20
Impact resistance (IK)	≥ 3
Certification	WEEE, CE
Insulation class	2
Supply	Self-contained
Monitoring	SelfControl (SC)
Bridging time	3 h
Battery	NIMH 4,8 V/2,0 Ah
Operating mode	Non-maintained / maintained
Input voltage AC	230 V
Input frequency	50 / 60 Hz
Power max.	3 W
Power maintained	1,6 W



Power non-maintained	0,35 W
Ambient temperature maintained mode	-5 °C to 40 °C
Ambient temperature non-maintained mode	-5 °C to 40 °C
Depth	24 mm
Width	50 mm
Height	12 mm
Installation dimensions Diameter	10.5 mm
Weight	0.34
Weight incl. packaging	0.42
Connection cross-section	2.5 mm <sup>2</sup>
Switching input	Yes
Emergency light blocking	Yes
Battery connection	Connector
Dimming function	Yes
Luminous flux mains	140 lm
Luminous flux emergency	140 lm
Customs tariff number	94056120
GTIN	4260349824446



## TECHNICAL DRAWING

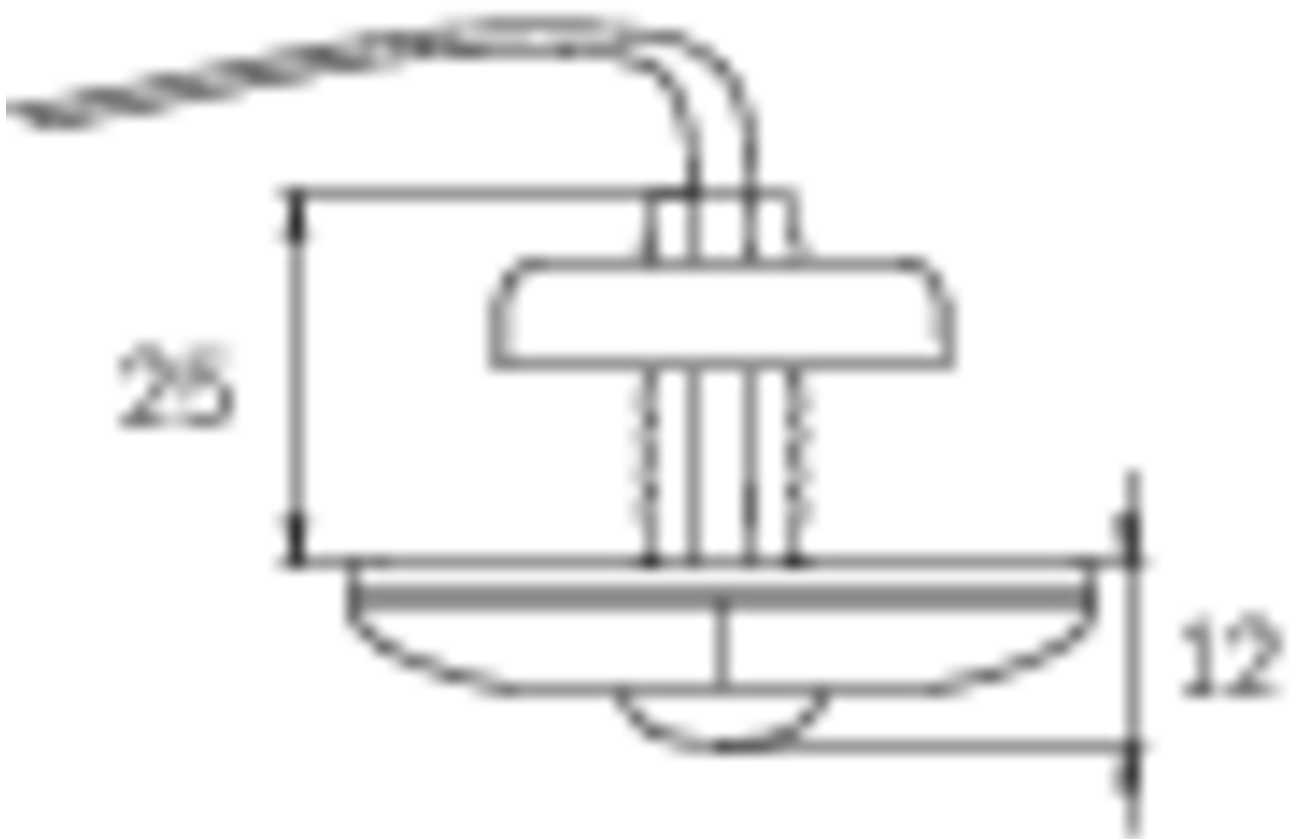
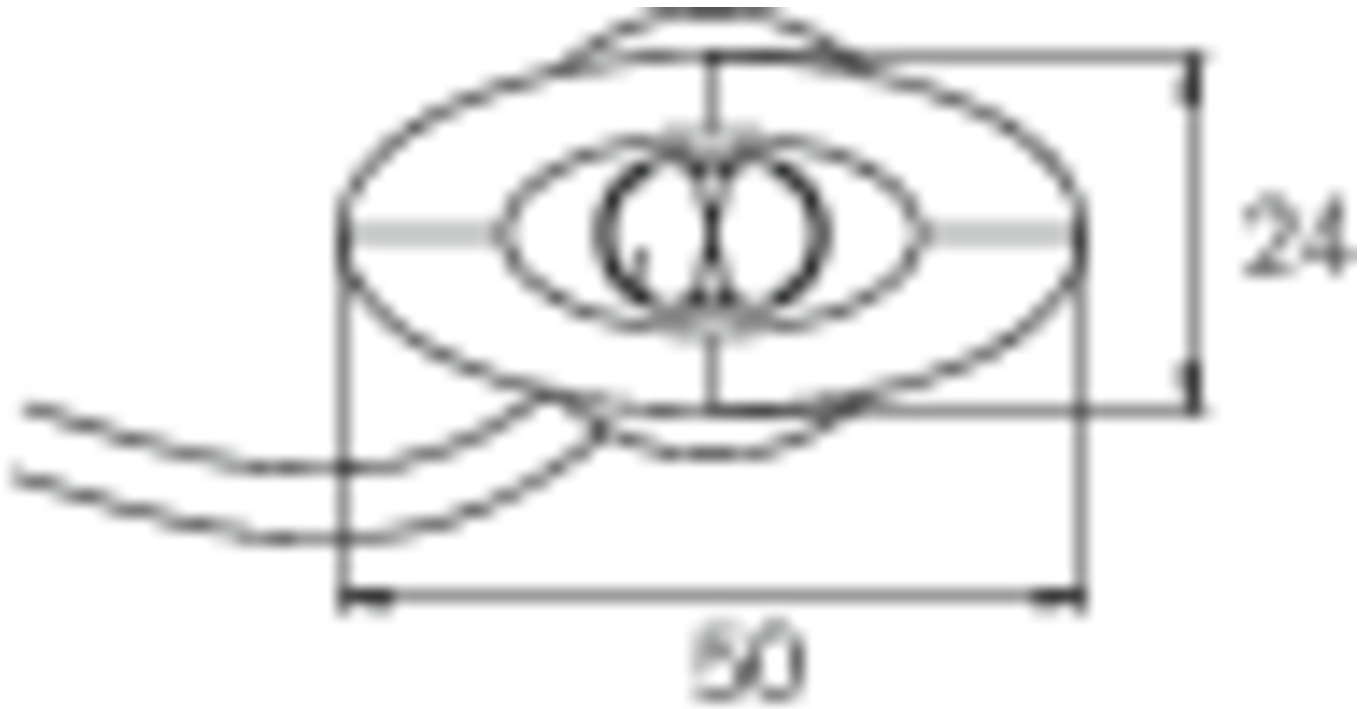

ø10.5

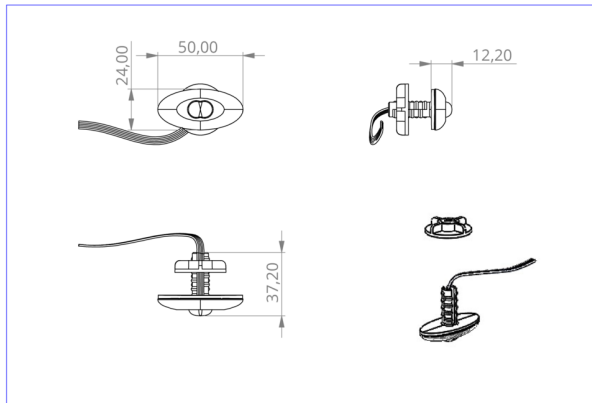
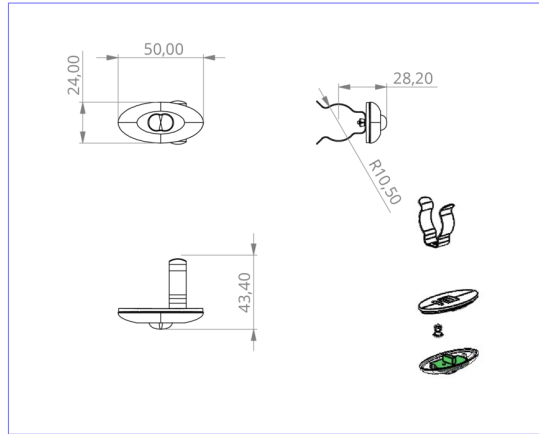
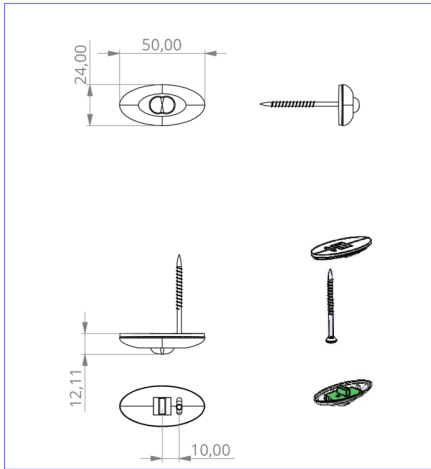

DO verschiedene Einbaumaße

## ACCESSORY LIST

NIMHHT4820Q - Battery

As of: 09.08.2025 - Subject to technical changes and errors.