



Art.-Nr: KFMU009ML
Exit sign Centralised power supply systems
Universal, Central power supply (ML), CPS, 20 m, IP40,
Polycarbonate, White

Slim and elegant emergency exit sign luminaire with convex, clear, closed surround, which tapers downwards in a continuous and symmetrical manner. Suited to universal mounting, i.e. fitting on a wall and ceiling, as well as for inscription on one or two sides. The pictograms are on the inside and are inserted without the use of solvents.

Control and monitoring via central power supply system. Planning certainty is provided by tool-free, variable use of the pictograms on site. A set of pictograms corresponding to DIN ISO 7010 (2x man in the door and 2 straight arrows) are supplied as standard.



More information
www.rp-group.com/en/item/KFMU009ML



TECHNICAL DATA

Luminaire type	Exit sign
Mounting	Universal
Recognition distance	20 m
Pictograph	Set
Illuminant	LED
Housing material	Polycarbonate
Housing color	White
Protection type (IP)	IP40
Impact resistance (IK)	5
Certification	CE, WEEE
Insulation class	2
Supply	Centralised power supply systems
Monitoring	Central power supply (ML)
Bridging time	CPS
Battery	/
Operating mode	single luminaire switching
Input voltage AC	230 V



Input frequency	50 / 60 Hz
Input voltage DC	216 V
Power max.	2,7 W
Power maintained	2,7 W
Power non-maintained	0,9 W
Ambient temperature maintained mode	-20 °C to 40 °C
Ambient temperature non-maintained mode	-20 °C to 40 °C
Depth	212 mm
Width	31 mm
Height	141 mm
Weight	0.25
Weight incl. packaging	0.35
Connection cross-section	2,5 mm ²
Switching input	No
Emergency light blocking	No
Battery connection	No
Dimming function	Yes
Customs tariff number	94056180
GTIN	4260766558511



TECHNICAL DRAWING

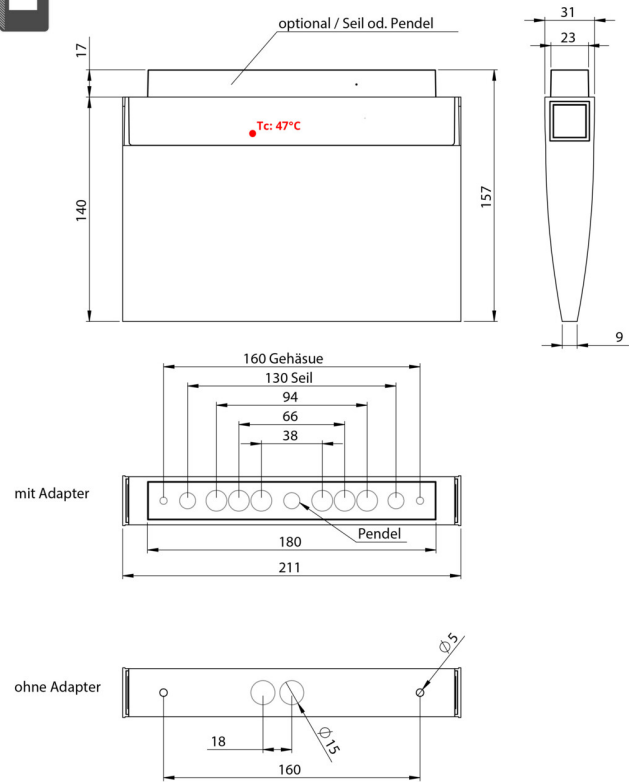
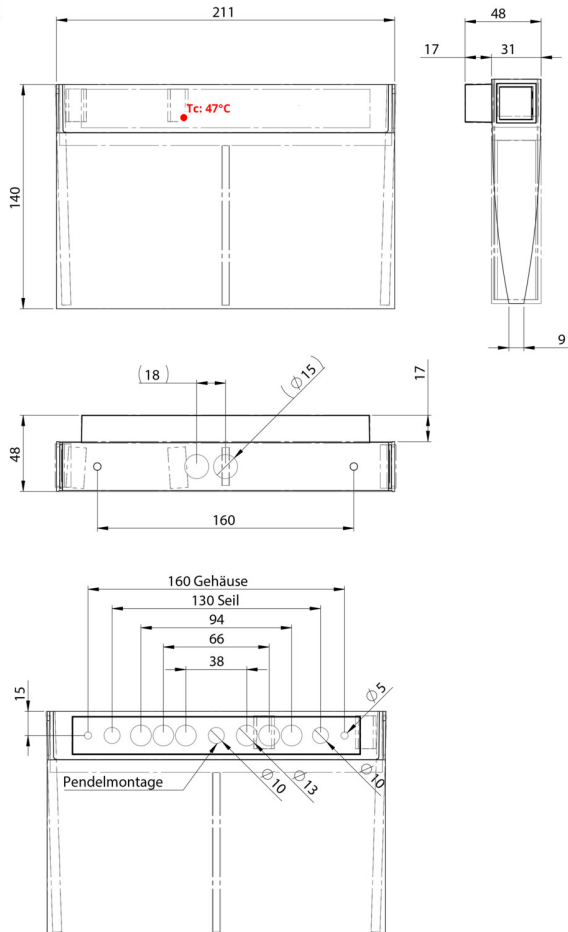

As of: 04.07.2025 - Subject to technical changes and errors.