



Art.-Nr: WKW413WL
Exit sign Self-contained
Wall mounting, Wireless Professional (WL), 3 h, 36 m, IP20,
Metal, White

Square emergency exit sign cube luminaire for wall mounting for illuminating escape and emergency routes.

The cube shape means that this plastic luminaire is easily recognisable from three sides. Ideal for large-scale applications, e.g. in large stores.

Wireless central control and monitoring for large installations of up to 50,000 luminaires with Wireless Professional. Planning certainty is provided by printed pictograms, determined on the basis of logic. The pictograms used correspond to DIN ISO 7010 (arrow to the right, left and down).



More information
www.rp-group.com/en/item/WKW413WL



TECHNICAL DATA

| | |
|------------------------|-----------------------------|
| Luminaire type | Exit sign |
| Mounting | Wall mounting |
| Recognition distance | 36 m |
| Pictograph | Set |
| Illuminant | LED |
| Housing material | Metal |
| Housing color | White |
| Protection type (IP) | IP20 |
| Impact resistance (IK) | ≥ 3 |
| Certification | WEEE, CE, 5 years warranty |
| Insulation class | 1 |
| Supply | Self-contained |
| Monitoring | Wireless Professional (WL) |
| Bridging time | 3 h |
| Battery | LiFePO4 3,2 V/3,3 Ah |
| Operating mode | Non-maintained / maintained |
| Input voltage AC | 230 V |
| Input frequency | 50 Hz |



| | |
|---|---------------------|
| Power max. | 4,8 W |
| Power maintained | 2,8 W |
| Power non-maintained | 0,8 W |
| Ambient temperature maintained mode | -5 °C to 40 °C |
| Ambient temperature non-maintained mode | -5 °C to 40 °C |
| Depth | 195 mm |
| Width | 195 mm |
| Height | 195 mm |
| Weight | 0.87 |
| Weight incl. packaging | 1.01 |
| Connection cross-section | 2.5 mm ² |
| Switching input | Yes |
| Emergency light blocking | Yes |
| Battery connection | Connector |
| Dimming function | Yes |
| Luminous flux mains | 220 lm |
| Luminous flux emergency | 470 lm |
| Customs tariff number | 94056180 |
| GTIN | 4260766558627 |



TECHNICAL DRAWING

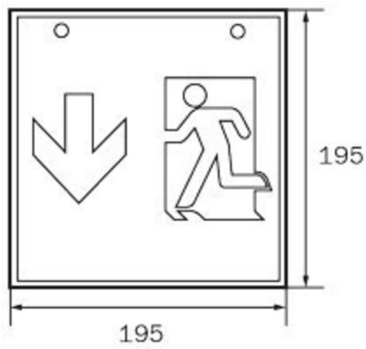

WK

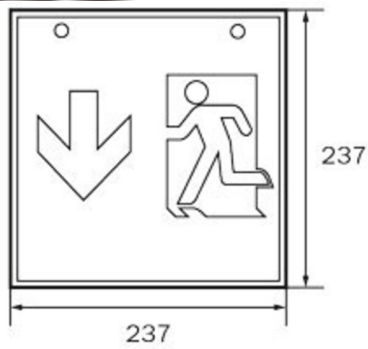

WG

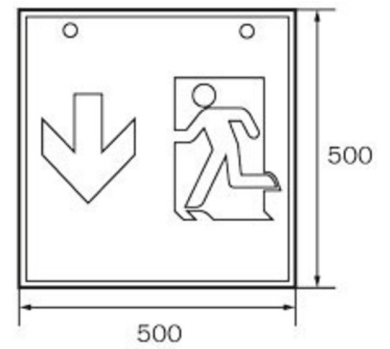

WX

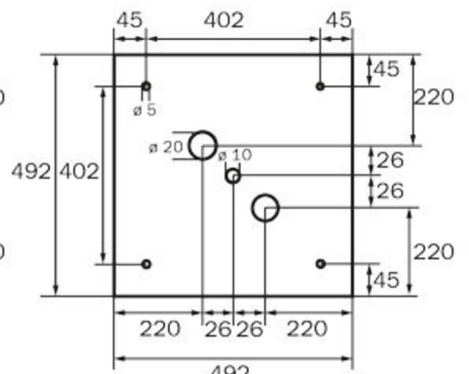

WX



ACCESSORY LIST

WKO -

As of: 12.12.2025 - Subject to technical changes and errors.