



Art.-Nr: ZAW013SC-AZ-COOL
Emergency light Self-contained
Wall mounting, SelfControl (SC), 3 h, , IP65, Zinc die-cast,
Anthracite

Robust wall-mounted Zinc die-cast luminaire for the lighting of escape and rescue routes in exit areas according to DIN EN 60598-1, DIN EN 60598-2-22 and EN 1838. Appealing design with concealed screws.

Available for central power systems or as a LED self-contained emergency luminaire.

The COOL light is equipped with an external battery housing for installation in the building. The installation of the lamp can be done outdoors or in cold stores.

Automatic monitoring of safety luminaire with SelfControl.



More information

www.rp-group.com/en/item/ZAW013SC-AZ-COOL



TECHNICAL DATA

| | |
|------------------------|-----------------------------|
| Luminaire type | Emergency light |
| Mounting | Wall mounting |
| Pictograph | No |
| Illuminant | LED |
| Housing material | Zinc die-cast |
| Housing color | Anthracite |
| Protection type (IP) | IP65 |
| Impact resistance (IK) | 8 |
| Certification | WEEE, CE |
| Insulation class | 1 |
| Supply | Self-contained |
| Monitoring | SelfControl (SC) |
| Bridging time | 3 h |
| Battery | LiFePO4 3,2 V/3,3 Ah |
| Operating mode | Non-maintained / maintained |
| Input voltage AC | 230 V |
| Input frequency | 50 / 60 Hz |
| Input voltage DC | - V |



| | |
|-----------------------------------------|---------------------|
| Power max. | 4,6 W |
| Power maintained | 3,3 W |
| Power non-maintained | 1 W |
| Ambient temperature maintained mode | -25 °C to 40 °C |
| Ambient temperature non-maintained mode | -25 °C to 40 °C |
| Depth | 65 mm |
| Width | 315 mm |
| Height | 140 mm |
| Weight | 2.1 |
| Weight incl. packaging | 2.22 |
| Connection cross-section | 2.5 mm ² |
| Switching input | Yes |
| Emergency light blocking | No |
| Battery connection | Connector |
| Dimming function | No |
| Luminous flux mains | 190 lm |
| Luminous flux emergency | 190 lm |
| Customs tariff number | 94056180 |
| EAN | 4260682140913 |

TECHNICAL DRAWING

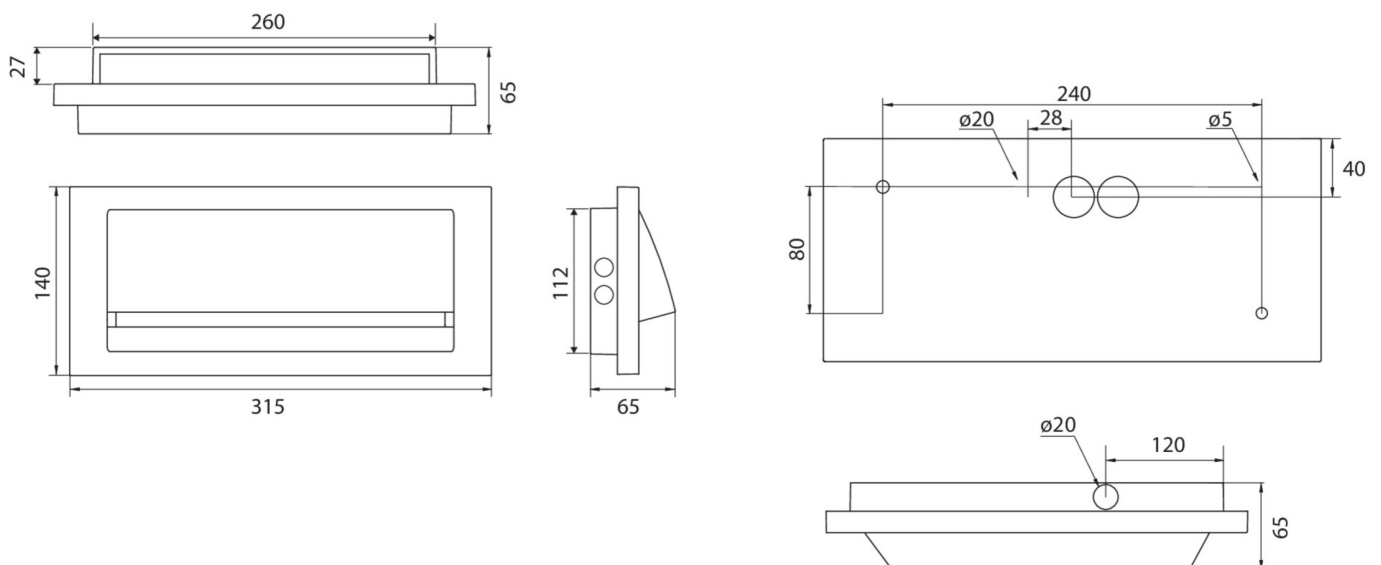

As of: 29.04.2025 - Subject to technical changes and errors.