



Art.-Nr: ZAW413WL-COOLIP54
Emergency light Self-contained
Wall mounting, Wireless Professional (WL), 3 h, , IP65, Zinc
die-cast, White

Robust, zinc die-cast wall surface-mounted luminaire for illuminating escape and emergency routes.

Particularly suited to illuminating escape and emergency routes at the exit and outside the building up to a safe zone. The radiating characteristics distribute the light parallel to the wall.

Wireless central control and monitoring for large installations of up to 50,000 luminaires with Wireless Professional.



More information

www.rp-group.com/en/item/ZAW413WL-COOLIP54



TECHNICAL DATA

| | |
|------------------------|-----------------------------|
| Luminaire type | Emergency light |
| Mounting | Wall mounting |
| Pictograph | No |
| Illuminant | LED |
| Housing material | Zinc die-cast |
| Housing color | White |
| Protection type (IP) | IP65 |
| Impact resistance (IK) | 8 |
| Certification | WEEE, CE, 5 years warranty |
| Insulation class | 1 |
| Supply | Self-contained |
| Monitoring | Wireless Professional (WL) |
| Bridging time | 3 h |
| Battery | LiFePO4 3,2 V/3,3 Ah |
| Operating mode | Non-maintained / maintained |
| Input voltage AC | 230 V |
| Input frequency | 50 / 60 Hz |
| Input voltage DC | - V |



| | |
|---|---------------------|
| Power max. | 5,3 W |
| Power maintained | 3,9 W |
| Power non-maintained | 1,5 W |
| Ambient temperature maintained mode | -25 °C to 35 °C |
| Ambient temperature non-maintained mode | -25 °C to 40 °C |
| Depth | 315 mm |
| Width | 65 mm |
| Height | 140 mm |
| Weight | 2.1 |
| Weight incl. packaging | 2.22 |
| Connection cross-section | 2.5 mm ² |
| Switching input | Yes |
| Emergency light blocking | No |
| Battery connection | Connector |
| Dimming function | No |
| Luminous flux mains | 190 lm |
| Luminous flux emergency | 190 lm |
| Customs tariff number | 94056180 |
| EAN | 4262483025031 |

TECHNICAL DRAWING

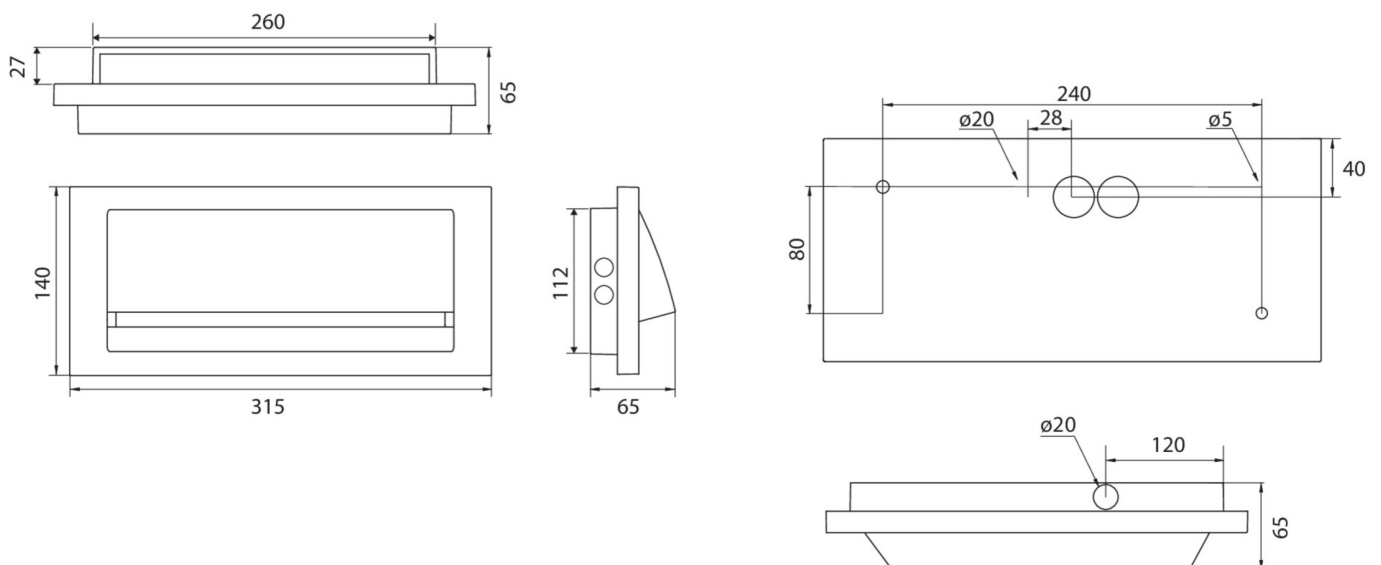

As of: 29.04.2025 - Subject to technical changes and errors.