



**Art.-Nr: ZAW519CC-AZ**

**Emergency light Centralised power supply systems  
Wall mounting, CoreCompact 24 (CC), CPS, , IP65, Zinc die-cast, Anthracite**

Robust, zinc die-cast wall surface-mounted luminaire for illuminating escape and emergency routes.

Particularly suited to illuminating escape and emergency routes at the exit and outside the building up to a safe zone. The radiating characteristics distribute the light parallel to the wall.

Control and monitoring via central 24 V low-power system.



More information

[www.rp-group.com/en/item/ZAW519CC-AZ](http://www.rp-group.com/en/item/ZAW519CC-AZ)



**TECHNICAL DATA**

Luminaire type	Emergency light
Mounting	Wall mounting
Pictograph	No
Illuminant	LED
Housing material	Zinc die-cast
Housing color	Anthracite
Protection type (IP)	IP65
Impact resistance (IK)	8
Certification	WEEE, CE, D-Sign
Insulation class	3
Supply	Centralised power supply systems
Monitoring	CoreCompact 24 (CC)
Bridging time	CPS
Battery	/
Operating mode	Non-maintained / maintained
Input voltageAC	24 V
Power max.	2,1 W
Power maintained	2,1 W
Power non-maintained	0,4 W



Ambient temperature maintained mode	-5 °C to 40 °C
Ambient temperature non-maintained mode	-5 °C to 40 °C
Depth	65 mm
Width	315 mm
Height	140 mm
Weight	1.96
Weight incl. packaging	2.08
Connection cross-section	2.5 mm <sup>2</sup>
Switching input	No
Emergency light blocking	No
Battery connection	No
Dimming function	Yes
Luminous flux mains	220 lm
Luminous flux emergency	220 lm
Customs tariff number	94056180
EAN	4260682157683

## TECHNICAL DRAWING

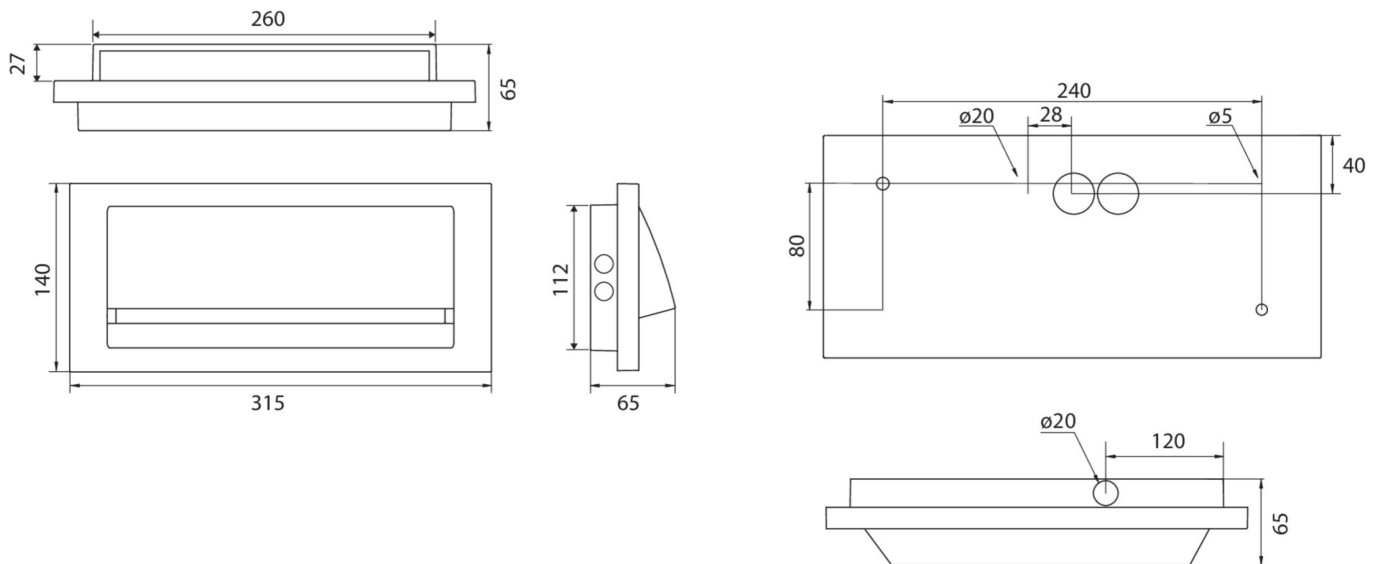

As of: 29.04.2025 - Subject to technical changes and errors.