



## Exit sign Art.-No.:

LED exit sign / emergency light according to DIN EN 60598-1, EN 60598-2-22, EN 7010 and DIN EN 1838.

Cuboid plastic housing design reduced on the lamps substance. Modular design and universal mounting for use as emergency luminaire with and without the application of pictograms. The modular system allows the luminaire to be converted to an exit sign luminaire at any time without dismantling or tools. Panes for mounting pictographs have to be ordered seperately.



### TECHNICAL DATA

Luminaire type	Exit sign
Mounting	Universal
Viewing distance	30 m
Pictograph	Set
Housing material	Kunststoff
Colour	RAL 9003
Mechanical rating IP	64
Impact resistance IK	5
Protection class	2
Ambient temperature maintained mode	-5 °C / 35 °C
Ambient temperature non-maintained mode	-5 °C / 35 °C
Length	326 mm
Width	50 mm
Height	50 mm
Weight	0.3 kg
Weight incl. Packaging	0.35 kg
Coutry of origin	Germany



## TECHNICAL DRAWING

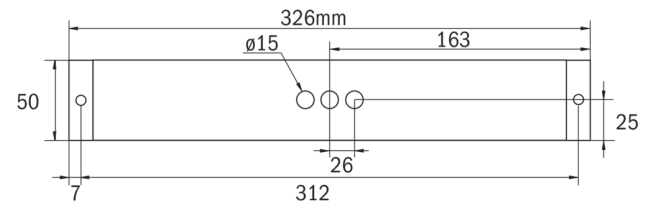
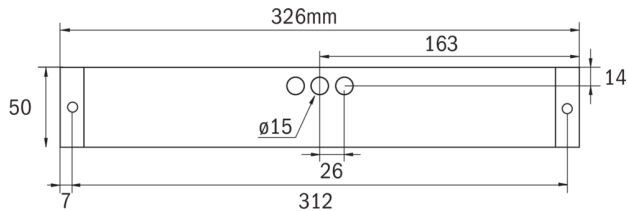

## ACCESSORIES

KBK	- KB disc VD 14m incl. pictoset
KBM	- KB disc VD 22m incl. pictoset
KBG	- KB disc VD 30m incl. pictoset
AWX001	- Wall bracket, white
KBE	- KB recessed frame - ABS white
BALLPLX-KBE	- Ball protection 415x171x31mm incl. fastening
BALLPLX-KBS	- Ball protection 410x322x77mm incl. fastening
BALLPLX-KBU	- Ball protection 300x140x77mm outside
2PW-EB	-
2DW-EB	-
KBBE	-
DSA	- cord suspension set 1,5m